



I-16

eduard

49 596

1/48 scale detail set for Eduard kit • sada detailů pro model 1/48 Eduard

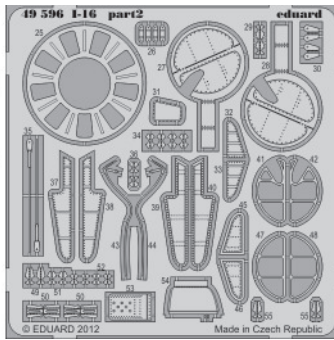
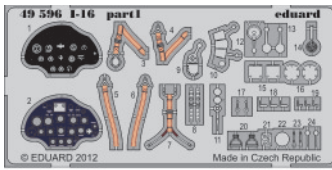

- APPLY EXPRESS MASK AND PAINT BEFORE GLUING
POUŽIT EXPRESS MASK NABARVIT PŘED SLEPENÍM
- SYMMETRICAL ASSEMBLY
SYMETRICKÁ MONTÁŽ
- REMOVE
ODSTRANIT
- GRIND
OBROUSIT
- DRILL HOLE
VRTAT OTVOR
- BEND
OHNOUT
- OPTION
VOLBA
- REPLACE
NAHRADIT

ORIGINAL KIT PARTS
PŮVODNÍ DÍLY STAVEBNICE

PHOTO-ETCHED PARTS
LEPTANÉ DÍLY

PARTS TO BE REMOVED
DÍLY K ODSTRANĚNÍ

FILL
TMELIT

The main assembly diagrams show the following steps:

- Top Left:** Assembly of the rear suspension area (B2) using parts 9, 17, E5, E13, E29, 13, and 22.
- Top Right:** Assembly of the front suspension area (B1) using parts 10, 24, E4, E29, and 12.
- Middle Left:** Assembly of the interior seat and floor components (F11, F12) using parts 3, 4, 5, 6, 7, 11, and 53.
- Middle Right:** Assembly of the engine compartment (F6) using parts 1, 2, 18, 19, 21, and 23.
- Bottom Left:** Assembly of the front suspension knuckle (E14) using parts 8 and 20.
- Bottom Center:** Assembly of the wheel hub (F14) using a ball pen and part 25.
- Bottom Right:** Assembly of the wheel (F7) using parts F16 and F22.

**DO NOT GLUE !
NELEPIT!**

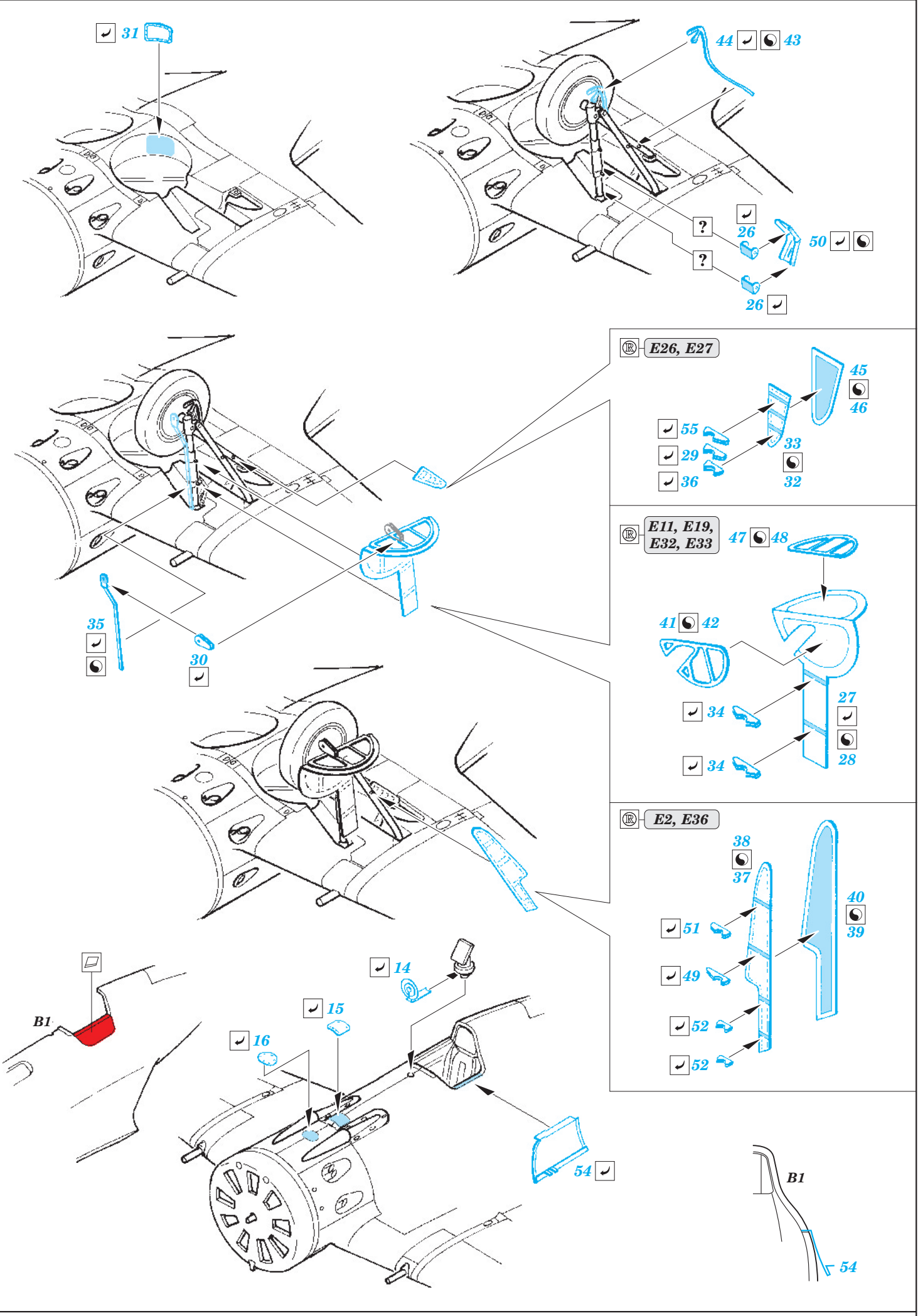

✓ 31

44 ✓ 43

? 26 ✓ 50 ✓
? 26 ✓

Ⓜ E26, E27

✓ 55 ✓ 29 ✓ 36
33 32
45 46

Ⓜ E11, E19, E32, E33

47 48
41 42
✓ 34 ✓ 34
27 28

Ⓜ E2, E36

38 37
40 39
✓ 51 ✓ 49 ✓ 52 ✓ 52

B1

✓ 14

✓ 15

✓ 16

54 ✓

B1

54